

### OVERVIEW

The Lanco Standard Applicator System is a high-accuracy applicator of self-adhesive components for use in manual or automatic assembly systems. The System's modularity makes it ideal for creating lean manufacturing cells and building semi or fully automatic systems. Parts fed by this method include various labels, gaskets, and other pressure sensitive adhesive-backed components with a maximum size of 60 mm wide x 100 mm long.

### MODULAR APPROACH

The Lanco Standard Applicator is composed of standard modules, which combine to allow the unit to be used in a variety of automation modes, from manual to fully automatic, by simply adding or removing modules. The expandable control system allows it to adapt to changing needs and to control an entire workcell, sparing the expense of an extra cell controller.

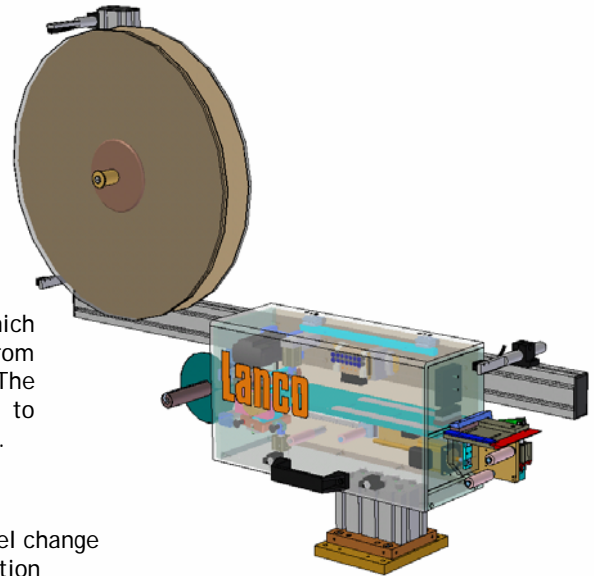

#### Supply Reel: features:

- Adjustable magnetic clutch tensioner
- Adjustable positioning for easy access/reel change
- Allows splicing of next roll while in operation
- Sensor detection of low material

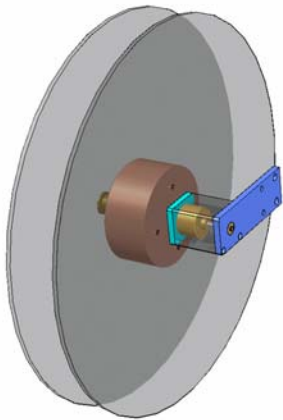

#### Applicator Module: Designed to work with 1 & 2 axis pneumatic devices and robots.

- Lanco can supply custom vacuum tooling to positively hold parts being applied
- Simple vertical placement as peeler plate retracts
- Pick & place motion allows next part feed during placement
- Robotic interface for multi-positioning or vision guiding

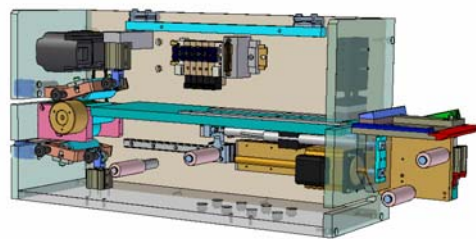

#### Carrier Take-Up: features:

- No rewind reel for carrier necessary
- Smooth stepper & magnetic clutch tensioning using feedback of the dancer arm position

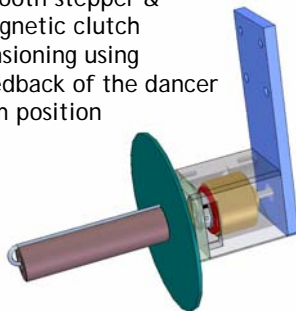

#### Tape Transport Unit: the core element of the system provides control of the carrier path & dispensing of self-adhesive parts.

- High accuracy placement using customized sensor positioning
- Stepper Motor Control to adjust part pitch, speed and pick position
- Peel plate and dancer arm position monitored by linear potentiometers for repeatability
- Air-actuated pinch roller drive for side loading of carrier. Quick-release pins for easy cleaning
- Transparent Door provides access to all internal parts

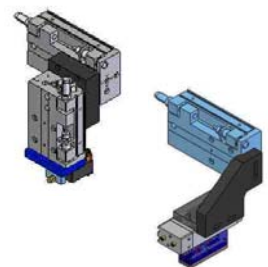

#### Control Module includes:

- Touchscreen MMI with programmable screens & menus
- PFC with Device Net or Ethernet capability for flexibility
- 8 inputs / 8 outputs standard; expandable
- Can be used to control complete automation cell
- Gives data for run-time, part count, cycle times
- Remote-mounted for easy access



#### Mounting Elements: attach the system to the machine environment where it is used, manual or automated, upright or inverted.

- Stanchion with X/Y jacking bolts for precise alignment
- Stanchion on sub-plate for direct table mount

